

# BEMIDJI COMMONS

2219 PAUL BUNYAN DRIVE NW, BEMIDJI, MN



KRAUS-ANDERSON®  
Realty Company

## SPACE AVAILABLE

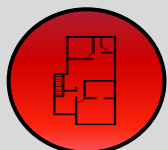

Multiple spaces available  
-see site plan

## SHOPPING CENTER



14,052 sf retail strip

## LOCATION



Intersection of US #2 &  
Hwy 71

## TRAFFIC COUNT



10,200/VPD on Hwy 71  
14,900/VPD on US #2



	1 Mile	3 Miles	5 Miles
POPULATION	2,515	14,329	22,063
DAYTIME POP	9,590	23,984	29,571
HOUSEHOLDS	1,131	5,728	9,109
HOUSEHOLD INCOME	42,444	54,373	60,679



# Retail Aerial



BEMIDJI COMMONS  
BEMIDJI, MN





# Aerial View



BEMIDJI COMMONS  
BEMIDJI, MN



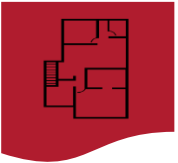

# Site Plan

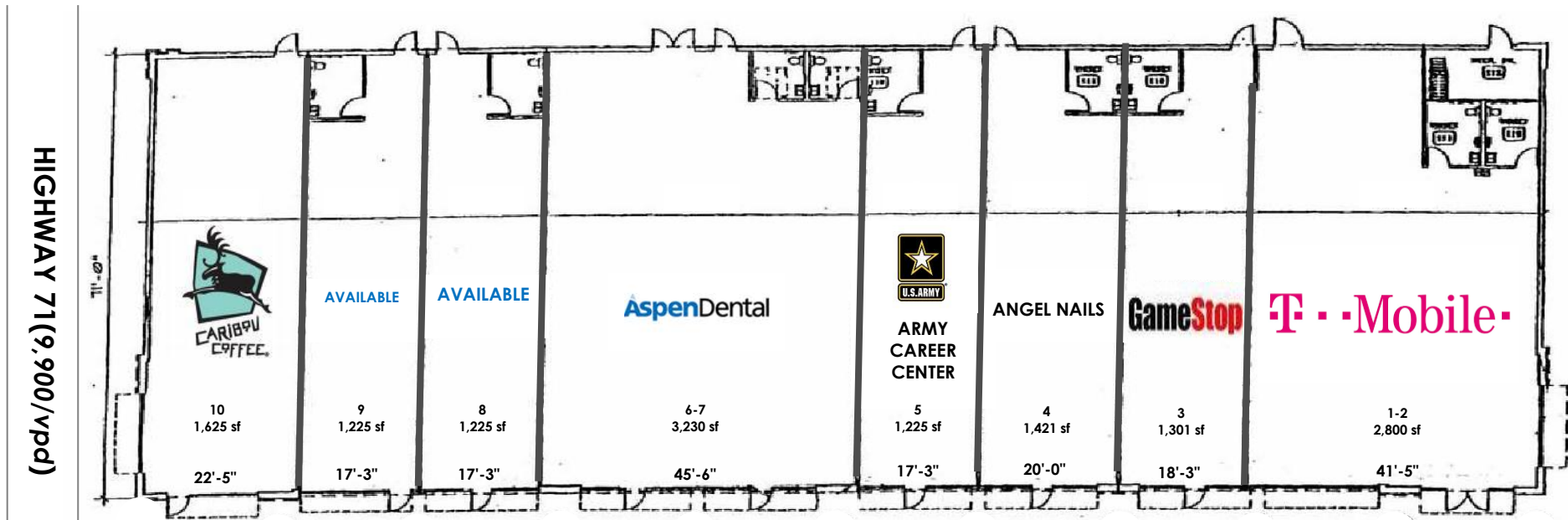

PAUL BUNYAN DRIVE NW / OLD US #2 (15,200/vpd)

US 2

**Bemidji Commons Shopping Center**  
 Site Area 1.45 Acres  
 Gross Leaseable Area 14,052 sf  
 Parking Stalls 69

BEMIDJI COMMONS  
 2219 PAUL BUNYAN DRIVE, BEMIDJI, MN





# Contact

---

## **Kraus-Anderson**

501 South Eighth Street  
Minneapolis, MN 55404

[www.krausanderson.com](http://www.krausanderson.com)

Main 612-332-7281  
Fax 952-881-8114



## **Dan Mossey**



O: 612-255-2420

C: 763-438-4751



[dan.mossey@krausanderson.com](mailto:dan.mossey@krausanderson.com)

## **Linda Autrey**



O: 218-759-3047

C: 218-766-8212



[linda.autrey@krausanderson.com](mailto:linda.autrey@krausanderson.com)