

NORMANDALE SHOPPING CENTER

5204-5250 WEST 84TH STREET, BLOOMINGTON, MN



KRAUS-ANDERSON[®]
Realty Company

SPACE AVAILABLE

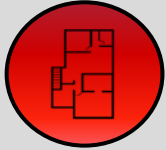

Multiple spaces available
- see site plan

SHOPPING CENTER



27,243 sf neighborhood
retail center

LOCATION



Intersection of
Normandale Boulevard
and W 84th St

TRAFFIC COUNT



58,000/VPD on
Normandale BLVD

18,700/VPD on W 84th St



| | 1 Mile | 3 Miles | 5 Miles |
|------------------|---------|---------|---------|
| POPULATION | 4,866 | 77,426 | 230,352 |
| DAYTIME POP | 24,797 | 136,609 | 276,916 |
| HOUSEHOLDS | 2,253 | 34,545 | 98,572 |
| HOUSEHOLD INCOME | 102,170 | 114,743 | 123,371 |



Retail Aerial

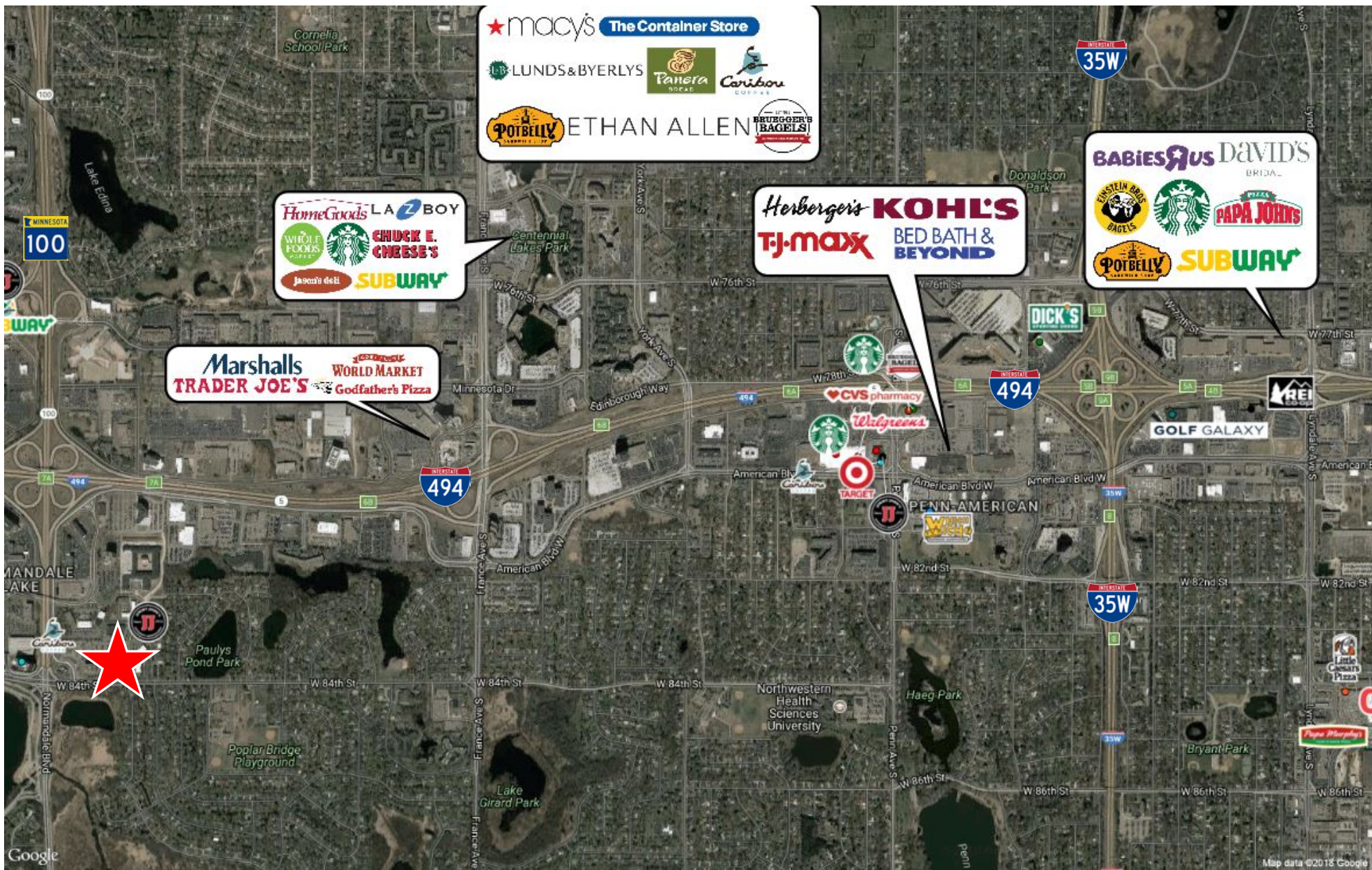

NORMANDALE SHOPPING CENTER
BLOOMINGTON, MN





Aerial View



NORMANDALE SHOPPING CENTER
BLOOMINGTON, MN



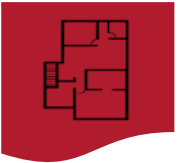

Site Plan



W. 84TH STREET (19,400/vpd)

AVAILABLE

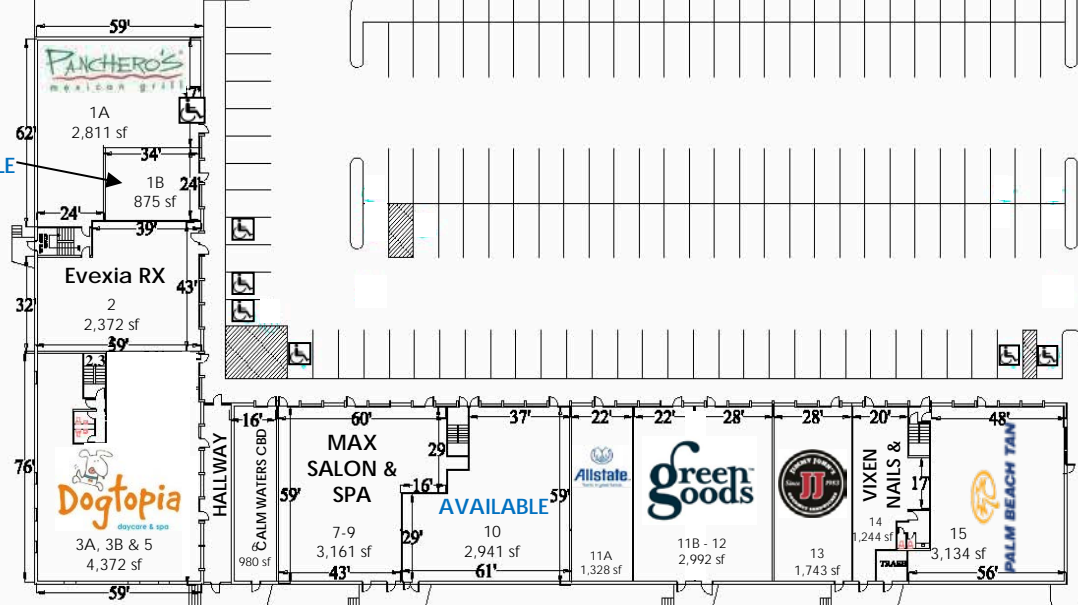

STANLEY ROAD



Normandale Shopping Center
 Site Area 5 Acres
 Leaseable Area 27,953 sf
 Parking Stalls 176



Contact

Kraus-Anderson

501 South Eighth Street
Minneapolis, MN 55404

www.krausanderson.com

Main 612-332-7281
Fax 952-881-8114



Dan Mossey



O: 612-255-2420

C: 763-438-4751



dan.mossey@krausanderson.com