

NORTHCOURT COMMONS

634-784 COUNTY ROAD 10 NE, BLAINE, MN

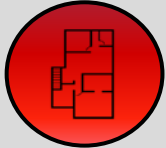

SPACE AVAILABLE



Multiple spaces available
– see site plan

SHOPPING CENTER



129,961 sf neighborhood shopping center. Area retailers include Target, Cub Foods, Best Buy, Home Depot, & LA Fitness

LOCATION



Located adjacent to Northtown Mall in the high traffic retail hub

TRAFFIC COUNT



21,900/VPD on Cty Rd 10



	1 Mile	3 Miles	5 Miles
POPULATION	7,251	71,682	212,237
DAYTIME POP	11,153	58,110	143,139
HOUSEHOLDS	2,955	27,506	79,293
HOUSEHOLD INCOME	74,527	84,224	91,692



Retail Aerial

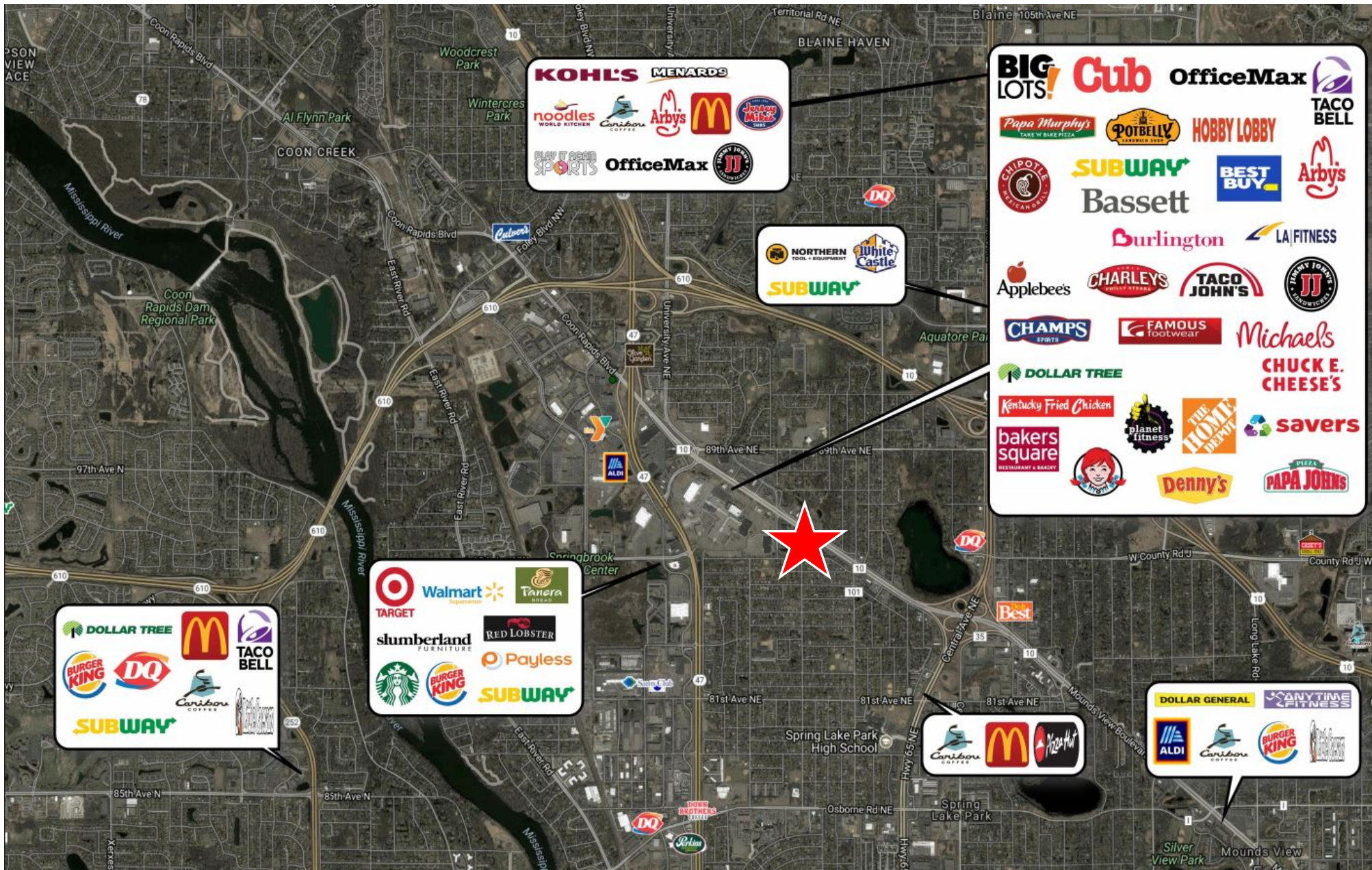

NORTHCOURT COMMONS
BLAINE, MN





Aerial View



NORTHCOURT COMMONS
BLAINE, MN



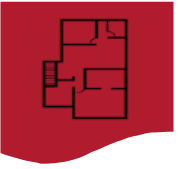

Site Plan

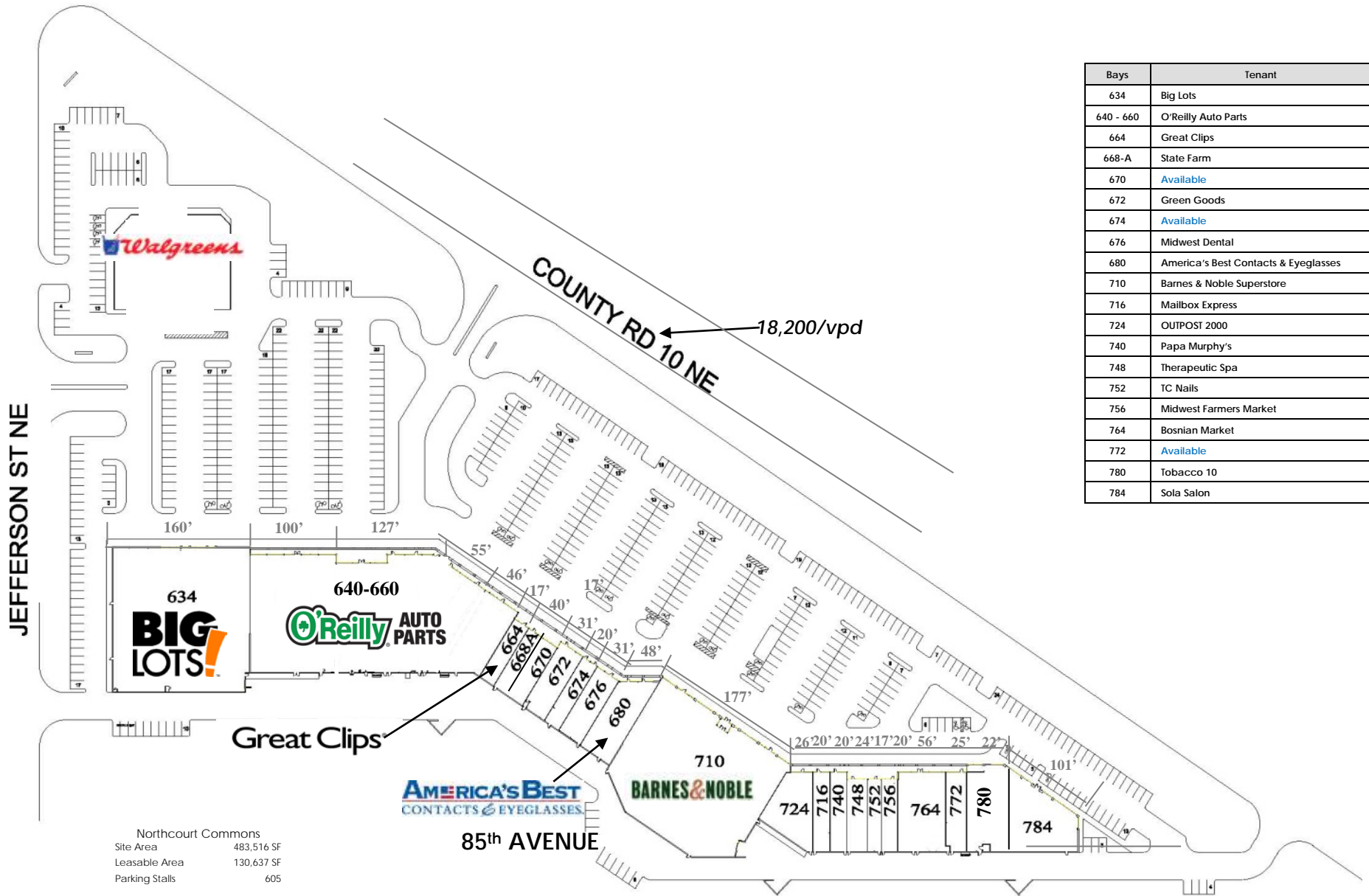

Bays	Tenant	SF
634	Big Lots	28,500
640 - 660	O'Reilly Auto Parts	32,652
664	Great Clips	1,520
668-A	State Farm	1,493
670	Available	1,547
672	Green Goods	2,520
674	Available	1,680
676	Midwest Dental	2,520
680	America's Best Contacts & Eyeglasses	3,816
710	Barnes & Noble Superstore	24,975
716	Mailbox Express	1,349
724	OUTPOST 2000	3,670
740	Papa Murphy's	1,780
748	Therapeutic Spa	1,951
752	TC Nails	1,289
756	Midwest Farmers Market	1,576
764	Bosnian Market	4,972
772	Available	2,208
780	Tobacco 10	4,288
784	Sola Salon	5,892

Northcourt Commons
 Site Area 483,516 SF
 Leasable Area 130,637 SF
 Parking Stalls 605



Contact

Kraus-Anderson

501 South Eighth Street
Minneapolis, MN 55404

www.krausanderson.com

Main 612-332-7281
Fax 952-881-8114



Dan Mossey



O: 612-255-2420

C: 763-438-4751



dan.mossey@krausanderson.com