

PLAZA 94 SHOPPING CENTER

1701-1901 WARD AVE, HUDSON, WI 54016



KRAUS-ANDERSON[®]
Realty Company

SPACE AVAILABLE

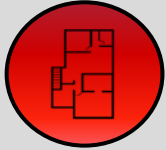

100% Leased

SHOPPING CENTER



90,895 sf neighborhood shopping center

LOCATION



Located on the north side of I-94 at exit #2, near the WI border in Hudson

TRAFFIC COUNT



83,200/VPD on I-94



	1 Mile	3 Miles	5 Miles
POPULATION	6,450	24,199	38,393
DAYTIME POP	7,981	19,557	30,936
HOUSEHOLDS	2,722	9,668	14,883
HOUSEHOLD INCOME	101,795	108,022	120,586



Retail Aerial

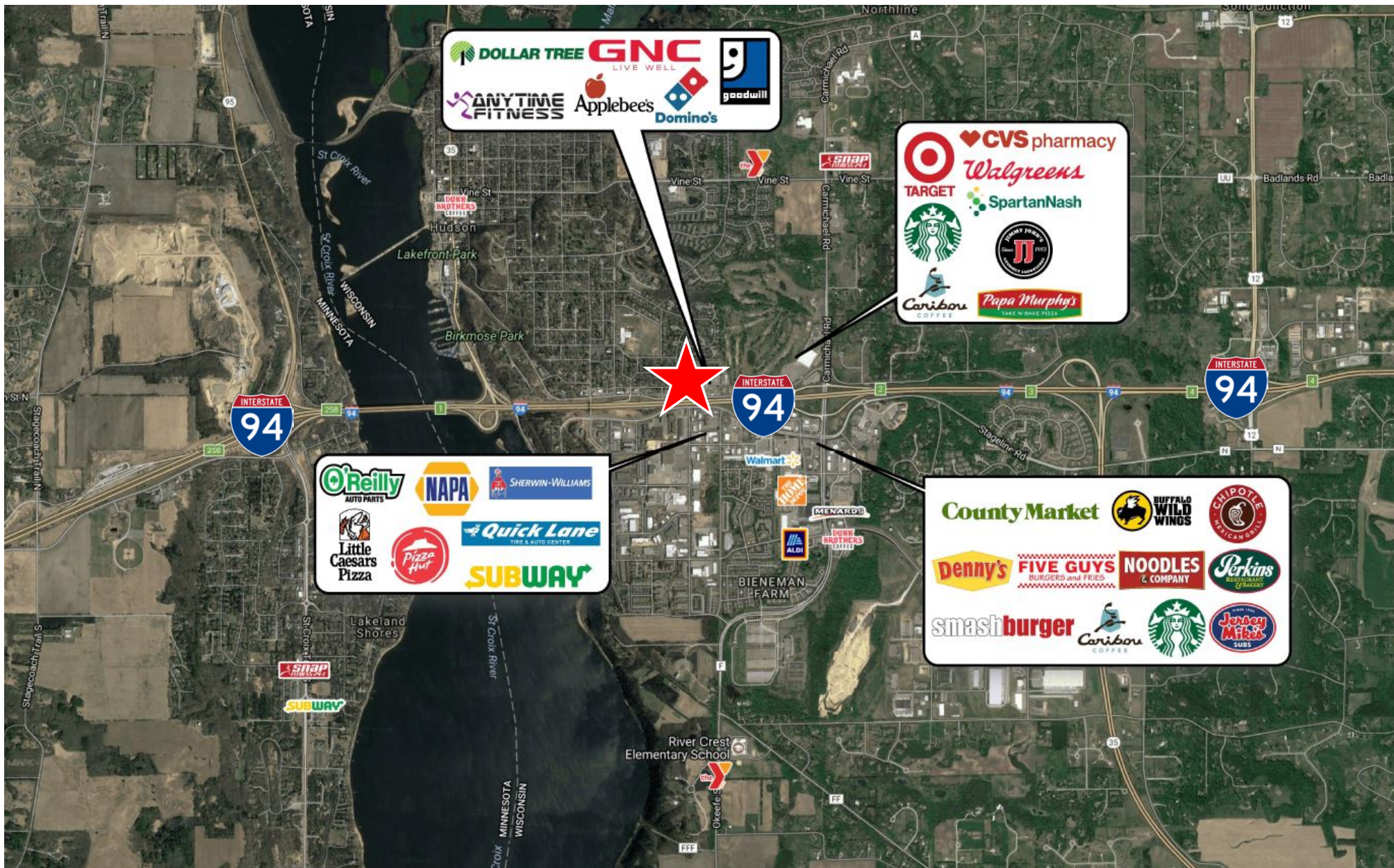

PLAZA 94 SHOPPING CENTER
HUDSON, WI





Aerial View



PLAZA 94 SHOPPING CENTER
HUDSON, WI



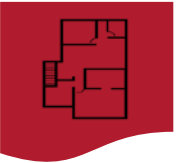

Site Plan

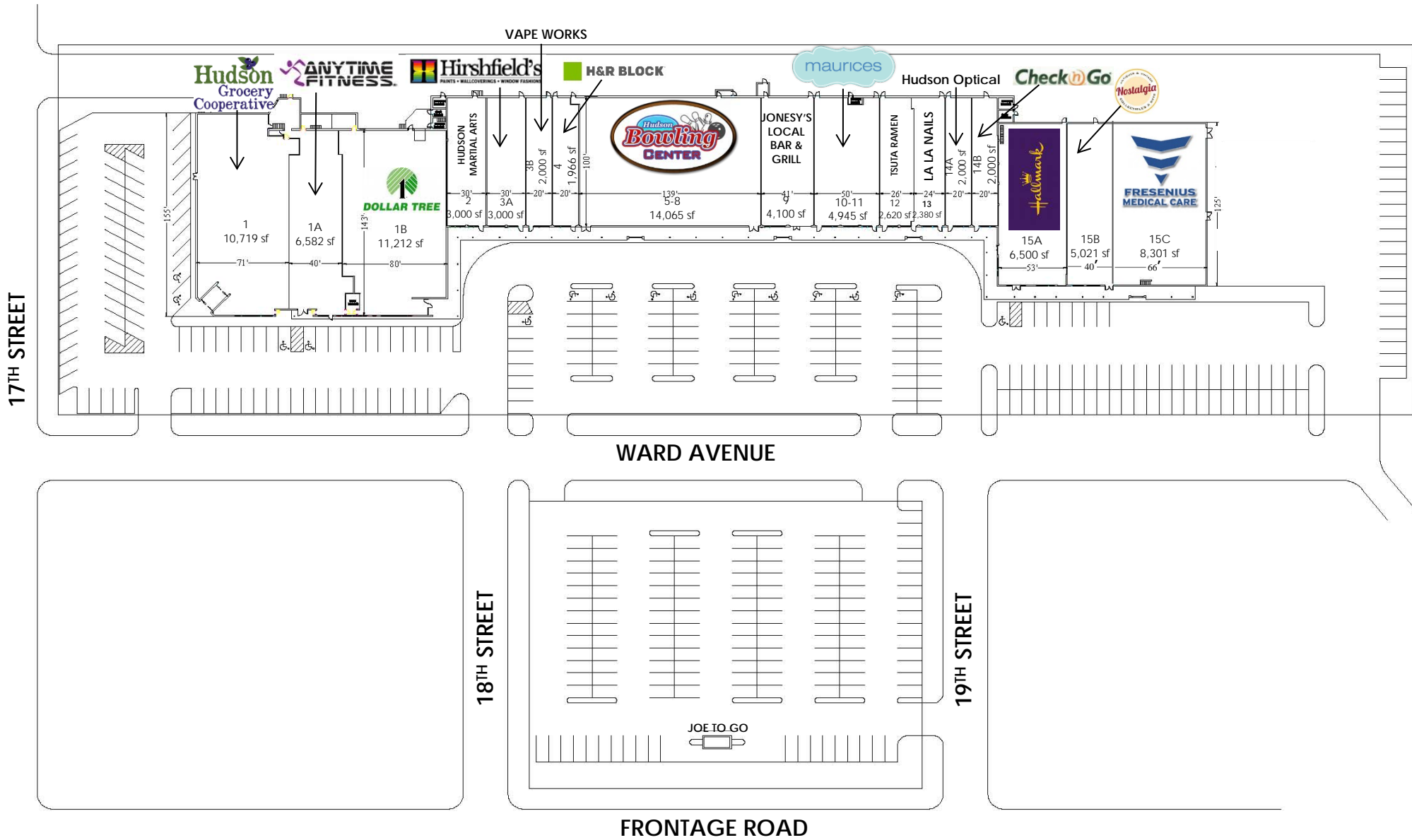

PLAZA 94 SHOPPING CENTER
 Site Area 357,627.60 SF
 Leaseable Area 90,411 SF
 Parking Stalls 440

I-94 (85,400/vpd)

12/7/23

PLAZA 94 SHOPPING CENTER
 1701 WARD AVENUE, HUDSON, WI





Contact

Kraus-Anderson

501 South Eighth Street
Minneapolis, MN 55404

www.krausanderson.com

Main 612-332-7281
Fax 952-881-8114



Dan Mossey



O: 612-255-2420

C: 763-438-4751



dan.mossey@krausanderson.com