

RIVERFRONT CENTRE

1100-1200 S. RIVERFRONT DRIVE, MANKATO, MN



KRAUS-ANDERSON®
Realty Company

SPACE AVAILABLE

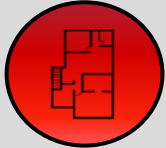

Multiple spaces available
- see site plan

SHOPPING CENTER



77,533 sf, Cub Foods
anchored shopping
center

LOCATION



Close to Downtown
Mankato and across the
street from Mankato West
High School

TRAFFIC COUNT



19,800/VPD on Riverfront
Drive

12,600/VPD on Stoltzman
Road



	1 Mile	3 Miles	5 Miles
POPULATION	13,144	55,904	61,741
DAYTIME POP	13,754	53,748	65,549
HOUSEHOLDS	5,148	22,678	24,996
HOUSEHOLD INCOME	66,518	70,523	73,896



Retail Aerial

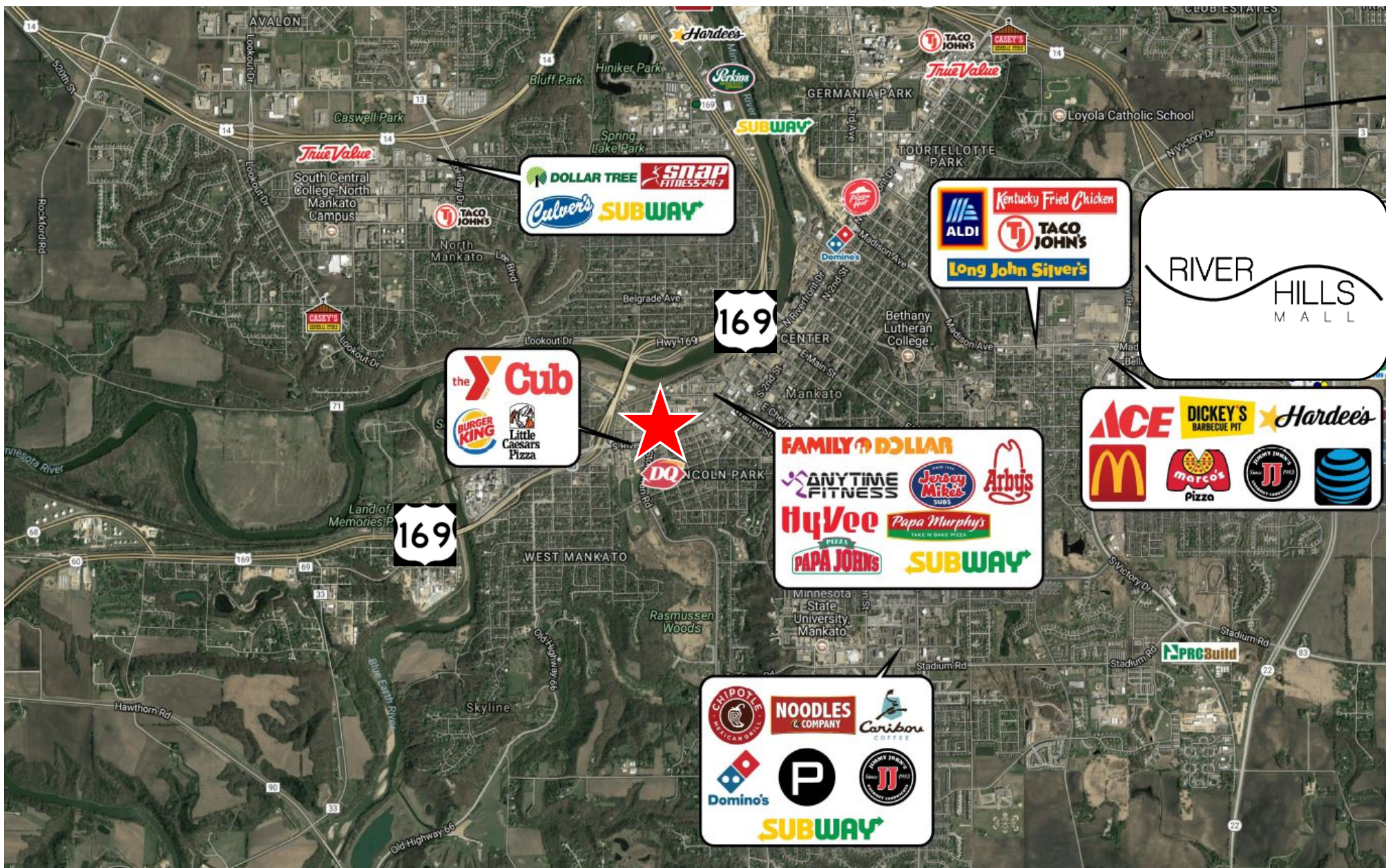

RIVERFRONT CENTRE
MANKATO, MN





Aerial View



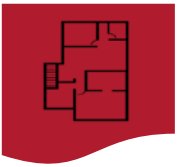

Site Plan

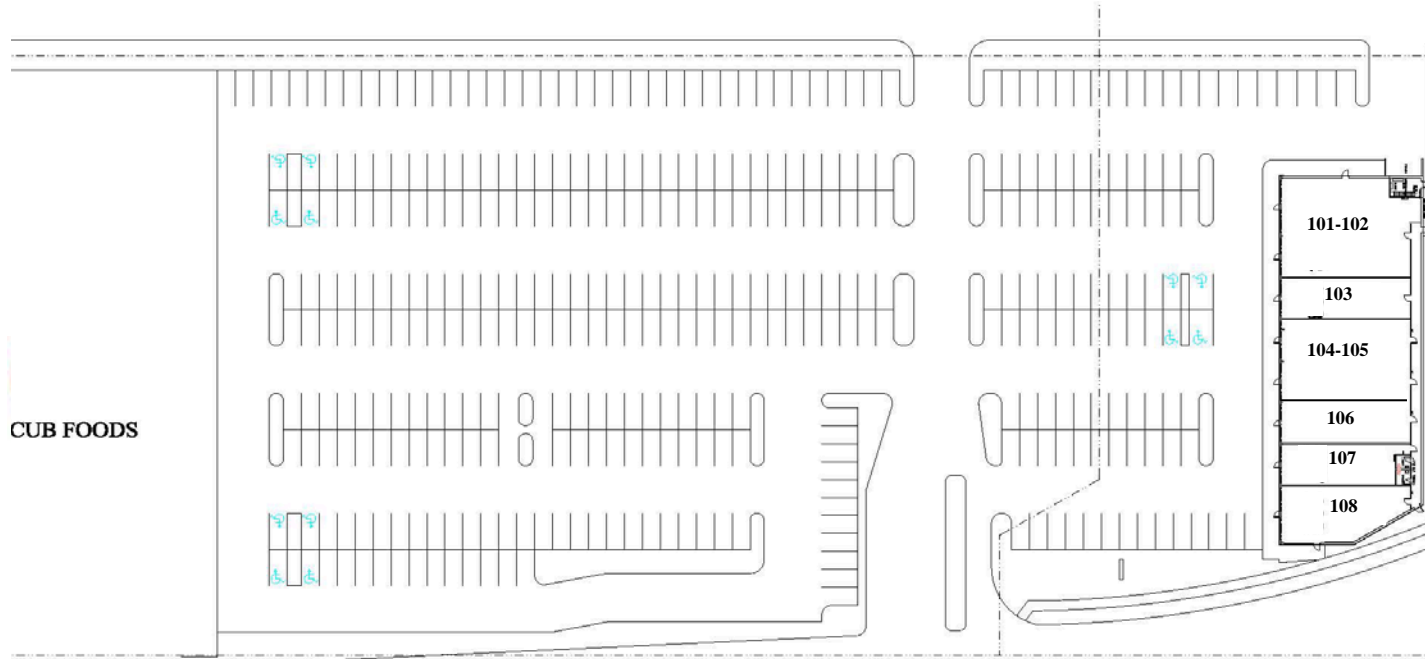

RIVERFRONT DRIVE (20,700/vpd)

Lease Plan
→

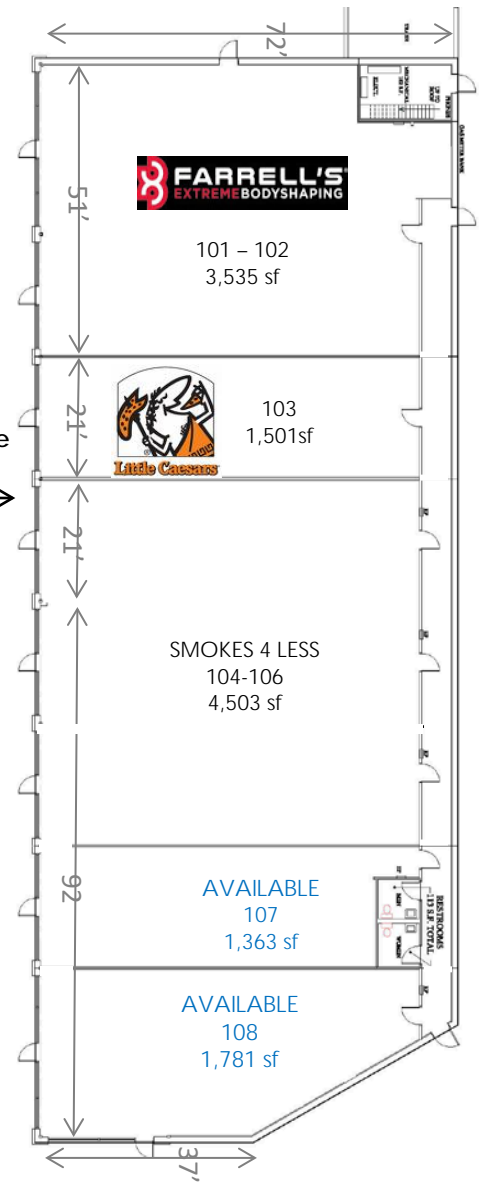

Riverfront Centre	
Cub Foods	64,850 SF
Retail	12,683 SF
Site Area	6.9 Acres
Leaseable Area	12,683 SF
Parking Stalls	375

11/22/23

RIVERFRONT CENTRE
1100 S. RIVERFRONT DRIVE, MANKATO, MN





Contact

Kraus-Anderson

501 South Eighth Street
Minneapolis, MN 55404

www.krausanderson.com

Main 612-332-7281
Fax 952-881-8114



Dan Mossey



O: 612-255-2420

C: 763-438-4751



dan.mossey@krausanderson.com