

SEASONS OFFICE BUILDING

8425 SEASONS PARKWAY, WOODBURY, MN



KRAUS-ANDERSON®
Realty Company

SPACE AVAILABLE



1,615 sf available -
see site plan

OFFICE BUILDING



23,230 sf, multi-tenant
Class "A" professional
building

LOCATION



Located in the Tamarack
Village business district
with excellent access to
494, 694, and 94

PARKING



Surface lot with ample
parking



AREA AMENITIES



20 minute drive to the
Minneapolis-St. Paul Airport



Great shopping nearby.
Valley Creek Mall, Woodbury
Village, Tamarack Village



15 minutes to downtown St. Paul



Down the road from newly
redeveloped City Place



Retail Aerial



SEASONS OFFICE BUILDING
WOODBURY, MN





Aerial View



SEASONS OFFICE BUILDING
WOODBURY, MN



KRAUS-ANDERSON
Realty Company

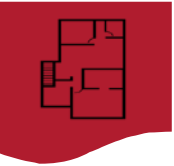

Site Plan

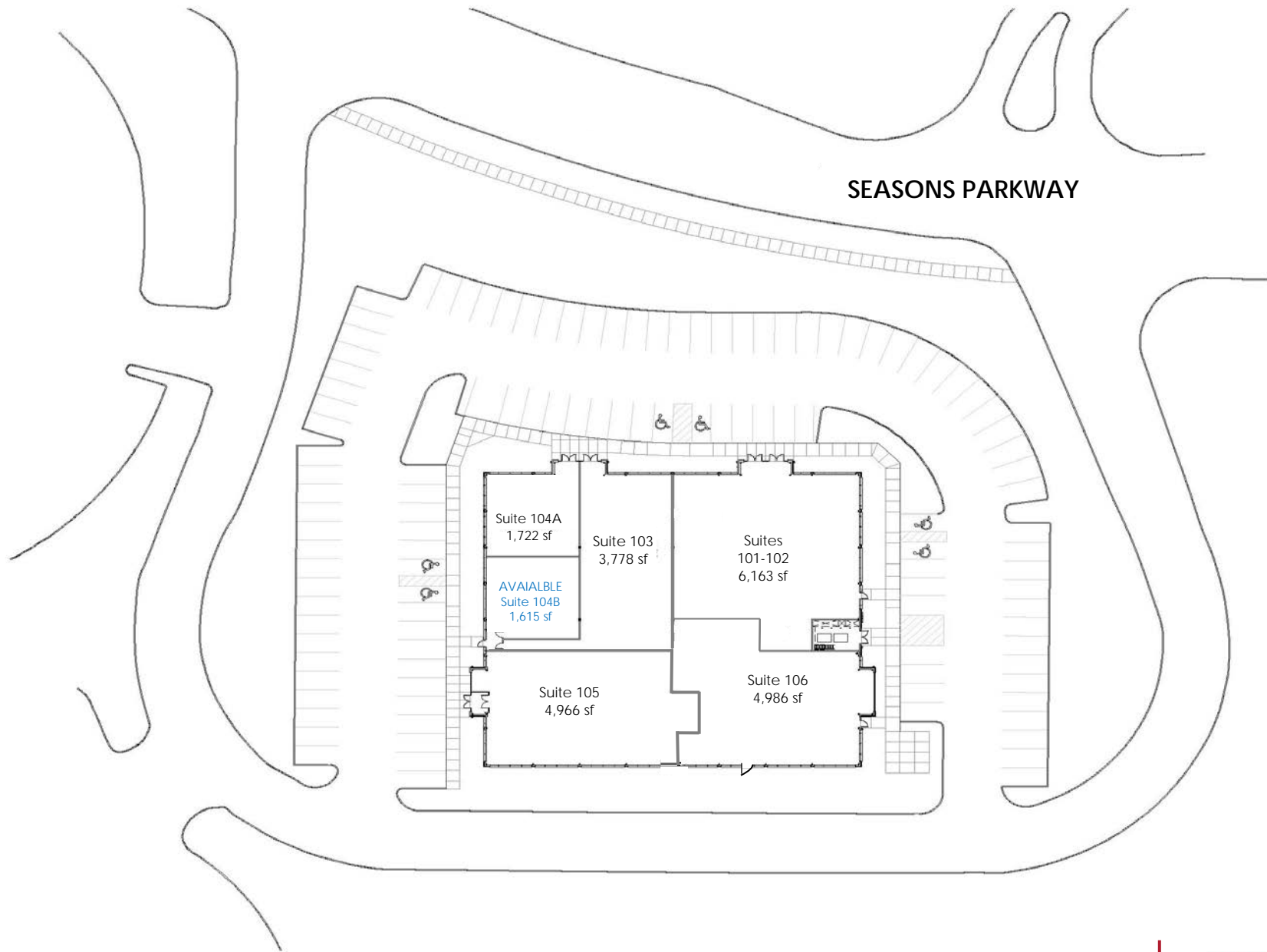

10/28/22

SEASONS OFFICE BUILDING
8425 SEASONS PARKWAY, WOODBURY, MN 55125



This architectural floor plan illustrates a building layout with specific lead shielding requirements. The plan includes several rooms and corridors, with lead thicknesses indicated in various areas:

- Top Right Room:** A room containing a sink and a toilet. Lead specifications include $1/8"$ LEAD on the top wall, $1/2"$ LEAD on the right wall, and $1/2"$ LEAD on the bottom wall.
- Bottom Right Room:** A room containing a sink, a toilet, and a trash can (TP). Lead specifications include $1/2"$ LEAD on the top wall and $1/2"$ LEAD on the bottom wall.
- Central Corridor:** A corridor connecting the rooms, with $1/2"$ LEAD specified on the right wall.
- Left Side:** A large open area with a sink and a trash can (TP). Lead specifications include $1/2"$ LEAD on the top wall and $1/2"$ LEAD on the bottom wall.
- Entrance/Exit:** A door is located on the left side of the plan, with $1/2"$ LEAD specified on the top wall.

The plan also shows various structural elements such as walls, doors, and furniture, providing a detailed view of the building's layout and shielding requirements.



Contact

Kraus-Anderson

501 South Eighth Street
Minneapolis, MN 55404

www.krausanderson.com

Main 612-332-7281
Fax 952-881-8114



Dave Stalsberg



O: 612-255-2348

C: 651-245-8010



dave.stalsberg@krausanderson.com